



Fan, DVS F/S GS

Installation Instructions (sku 99000159)

Packing List

- Blower Assembly
- Wiring Harness
- Rheostat
- Snap Disc
- Rheostat Nut and Knob
- Mounting Hardware - Stud Plate, (2) Grommets, (2) Bushings, (2) Washers, (2) Nuts

Warnings

WARNING: Make sure power to the stove has been shut off prior to installation (Unplug the stove). Do not connect 110-120 VAC to the gas control valve or wiring system of this appliance.

NOTE: Install the blower prior to connecting the gas line or installing the stove. If using the GreenSmart™ remote, install it after the blower is in place.

NOTE: If using the GreenSmart™ remote, refer to the special instructions below (GS1 or GS2). When using the GreenSmart™ remote, certain installation steps may be disregarded or altered.

Special Instructions for GreenSmart™ 2 Remote (GS2)

When using the GS2 remote, power for the blower is routed through the fuse and IFC, bypassing the rheostat and snap disc included with the blower kit (these items may be kept for spare parts).

HINT: Install the blower(s) with the IFC removed. Connect the wiring as shown below.

Disconnect the blower power input (see “a” below). Connect the blower wiring harness to the fuse output (see “b” below). Disconnect and discard the electrical line intended to connect the snap disk to the rheostat (carefully remove the wire tie from the wiring harness – see “c”). Attach the jumper wire (included with the remote) to the wires labeled “SNAP DISC” (see “d” below). Attach the blower power input (see “e”) to “FAN” lead on the fuse harness (pre-connected to the IFC). This circuit bypasses the rheostat and snap disc (these components included with the blower kit are not used and may be kept for replacement part purposes).

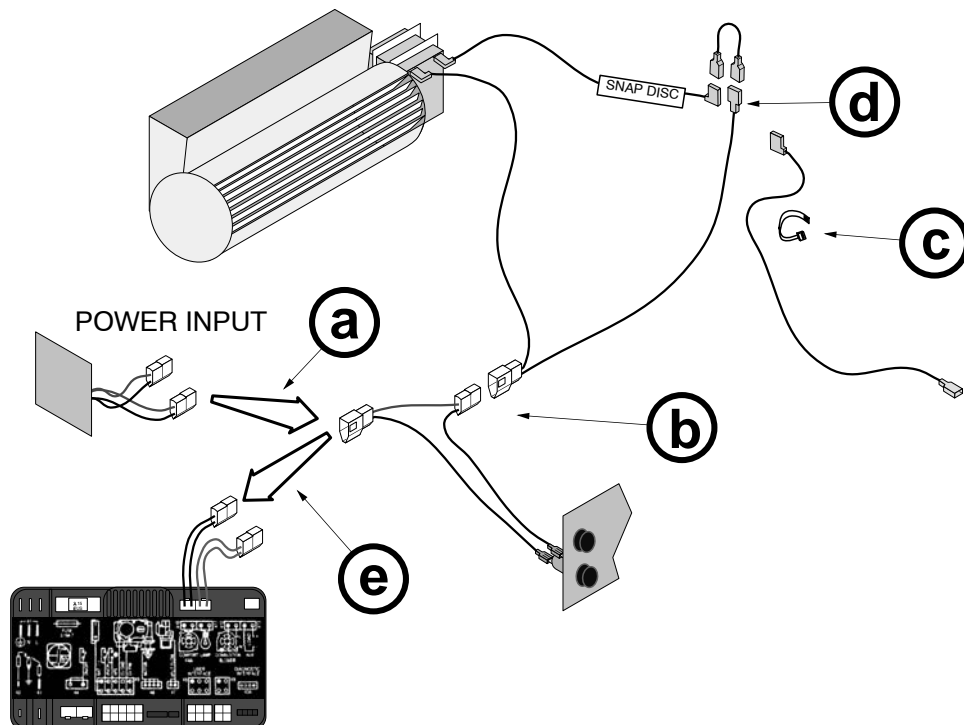



Fan, DVS F/S GS

Installation Instructions (sku 99000159)

Special Instructions for GreenSmart™ 1 Remote (GS1)

When using the GS1 remote, the rheostat is bypassed and the power connected to the fan extension module.

Disconnect and discard the electrical line that leads from the snap disk to the rheostat (carefully remove the wire tie and "SNAP DISK" label from the wiring harness – see "a"). Attach the lead from the power input to the snap disk (see "b"). Attach the wiring harness molex to the power lead (included with the remote – see "c"). Then plug the power lead into the outlet labeled "FAN" on the fan control module. Disregard the instructions for installing the rheostat (steps 6 through 9) or attaching power to the wiring harness (step 4).

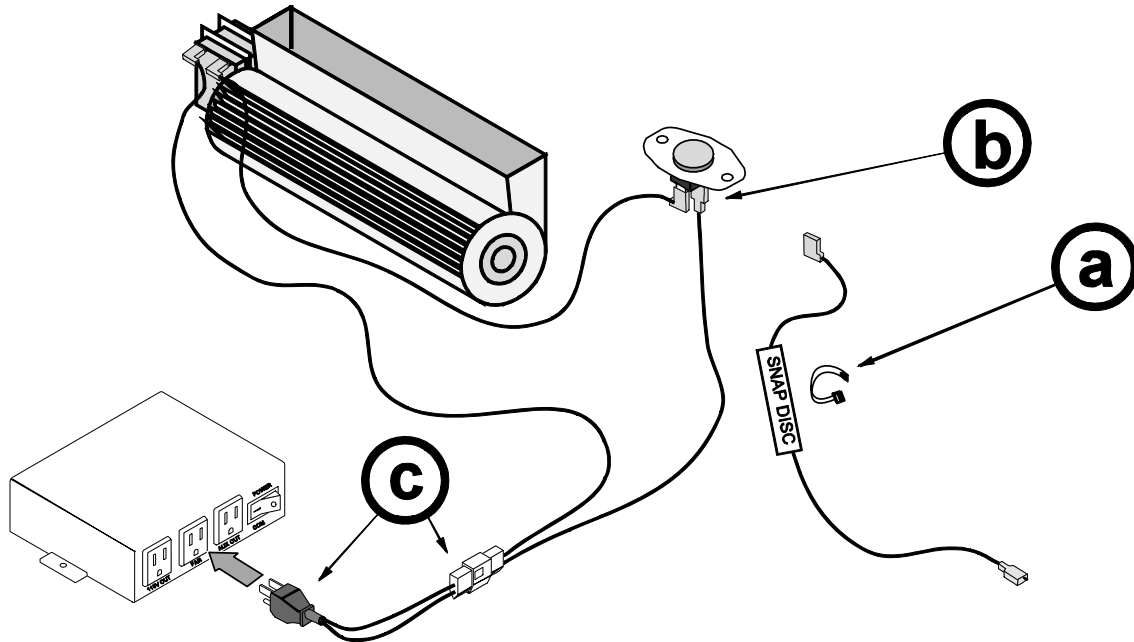

Installation

- 1 Loosen the bottom panel attachment screws (there are two on each side see Figure 1). Slide the bottom panel back and place it below the stove (see Figure 2). This allows for quick access to the controls under the stove.

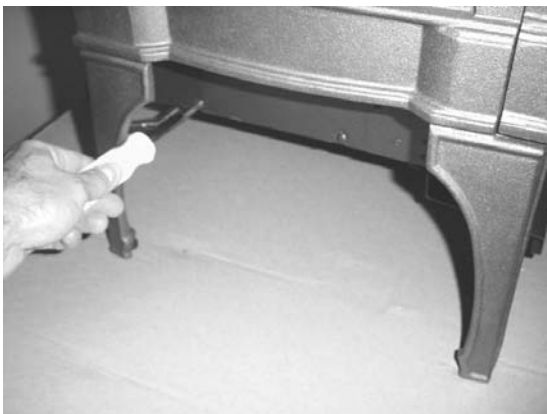

Figure 1



Figure 2



Fan, DVS F/S GS

Installation Instructions (sku 99000159)

- 2 Remove the cover plate behind the gas control valve used to conceal the hole for the snap disc (see Figure 3). Attach the included snap disc in this location(see Figure 4).



Figure 3



Figure 4

- 3 Place the blower near the back of the stove and attach the two wires on the wiring harness labeled "BLOWER" to the blower (orientation does not matter – see Figure 5). Attach the two wires labeled "SNAP DISC" to the snap disc (orientation does not matter – see Figure 6).

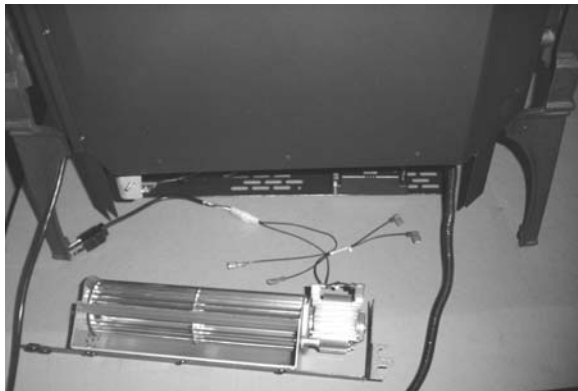

Figure 5

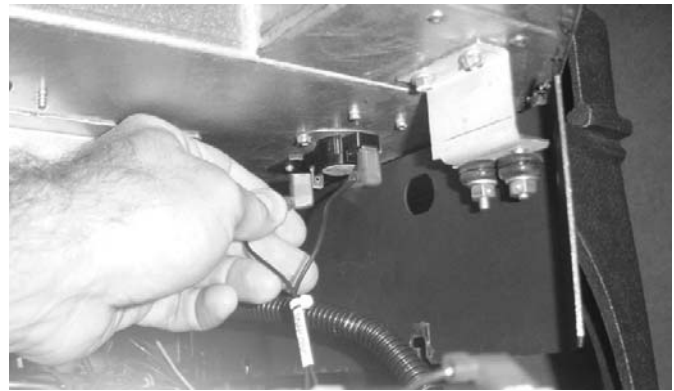

Figure 6

- 4 Plug the power cord on the wiring harness into the receptacle on the stove (see Figure 7).



Figure 7



Fan, DVS F/S GS

Installation Instructions (sku 99000159)

5 Install the blower (see Figure 8).

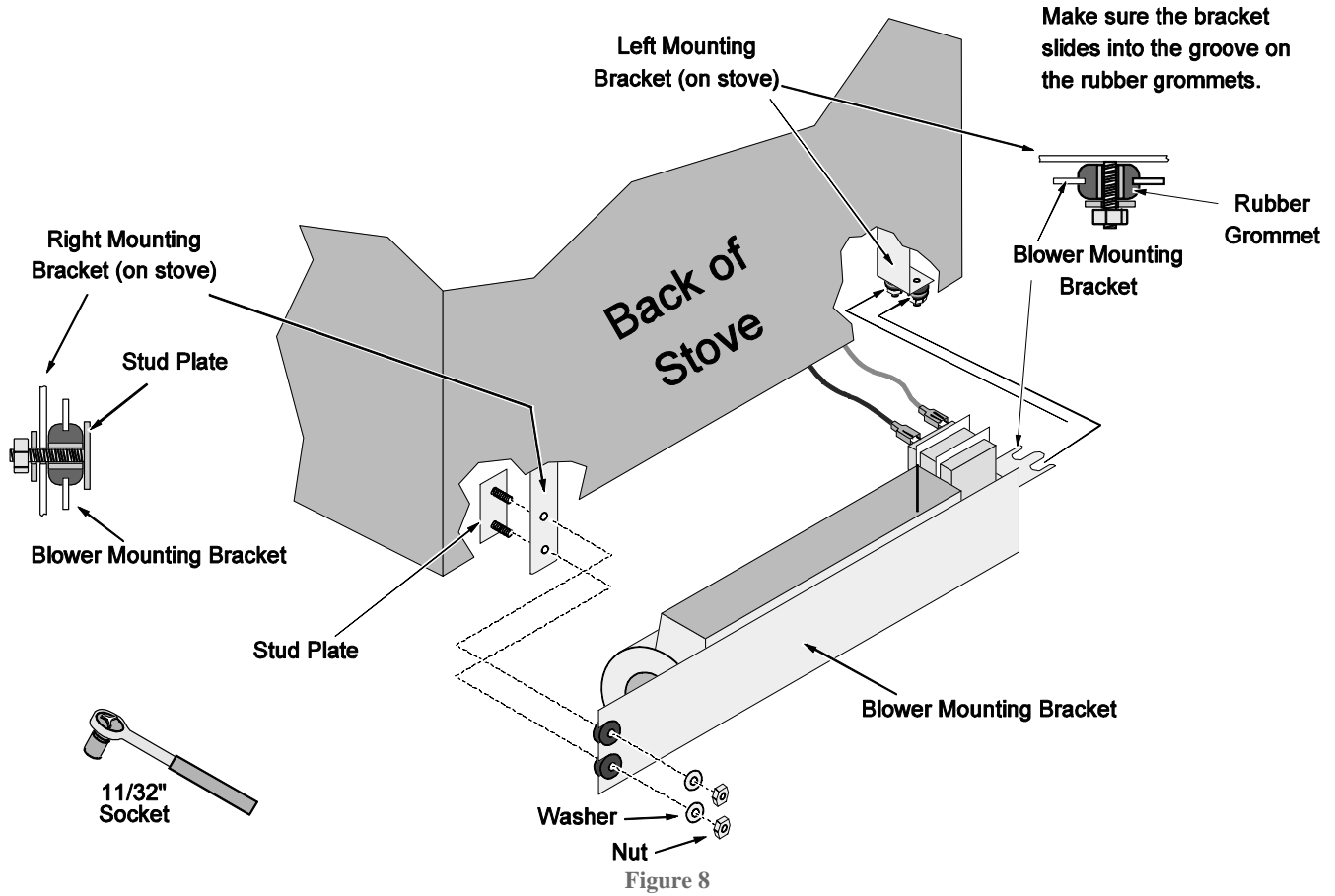



Fan, DVS F/S GS

Installation Instructions (sku 99000159)

- 6 Remove the four screws holding the control panel to the front of the stove (see Figure 9). Carefully remove the control panel, making sure you do not disconnect any wiring (see Figure 10).

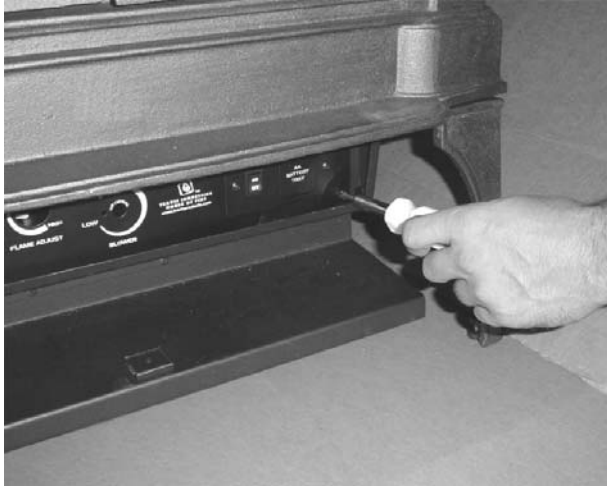

Figure 9

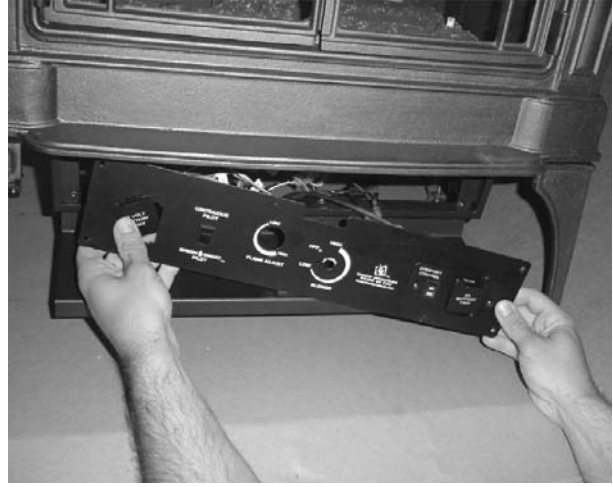

Figure 10

- 7 Connect the leads on the rheostat to the wires marked "RHEOSTAT" on the wiring harness (see Figure 11).

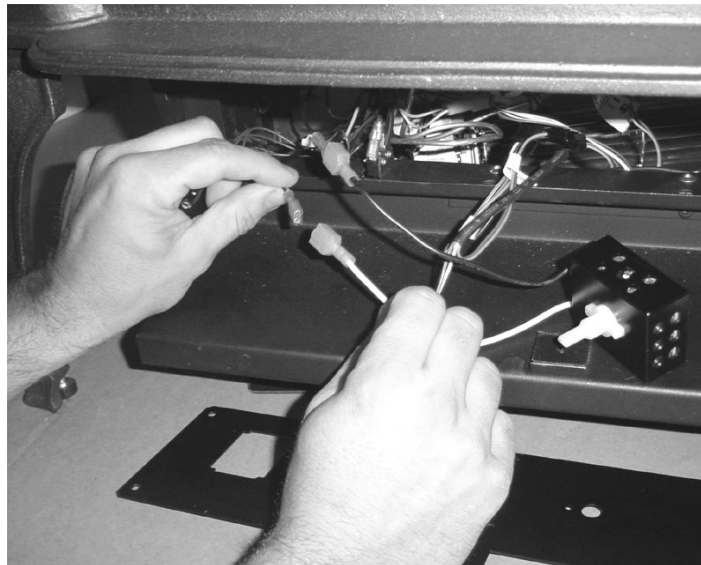

Figure 11



Fan, DVS F/S GS Installation Instructions (sku 99000159)

- 8 Insert the shaft on the rheostat through the control panel. Make sure the orientation-tab on the rheostat lines up with the orientation-hole on in the control panel. Secure the rheostat using the press nut (see Figure 12). Place the rheostat knob on the rheostat (see Figure 13).



Figure 12



Figure 13

- 9 Re-attach the control panel, making sure no wiring is pinched or damaged.
- 10 Before re-attaching the bottom panel, verify that all wiring is secure and does not contact any moving or hot surfaces. Use wire ties, if necessary, to secure the wiring. Replace the bottom panel and return the stove to the correct configuration.