



*Pellet Stoves  
Wood Stoves  
Multi-Fuel Stoves  
Pellet Grills*

P.O. Box 206

Monroe, VA 24574

[www.heatredefined.com](http://www.heatredefined.com)

Phone: (800) 516-3636

Fax: (434) 929-4810

## Auger Bearing and Auger Bearing Gasket Replacement

***WARNING: BE SURE TO READ YOUR OWNER'S MANUAL BEFORE INSTALLING OR OPERATING YOUR STOVE.  
ALWAYS FOLLOW ALL CODES.***

***Be sure the stove is unplugged and cooled before performing any maintenance/component replacement.***

***NOTE: These instructions are also included on the service DVD that came with your unit.***

The bearing gasket comes in two different styles: The **fiberglass** (soft, Part PU-ABG) type (which was primarily used on earlier model units, 2001 and older) and the **nylon** (hard, Part PU-ABGN) type (which is used on our current units, 2002 to present). They are both replaced by first removing the auger bearing (PU-UCF204-12).

Remove the access panel from the stove so that you can access the auger motor. Using a 5/16" socket/open ended wrench or a 3/8" 12 point socket, loosen the auger set bolt, then remove the auger motor. Next, loosen and remove the four bolts on the auger bearing. Slide the auger/bearing assembly out. Remove the 3/4" collar on the auger shaft. Then, using a 1/8" allen wrench, loosen the two set screws on the bearing and slide the bearing off. (*If replacing the bearing only, skip the next step and proceed to install the new bearing.*) The gasket should come with it, but if not, slide the gasket off. If using the fiberglass gasket, you may need to scrape any residue off the back of the bearing.

To replace, slide the new gasket onto the auger shaft (if replacing the **nylon** gasket, make sure the smooth side is facing AWAY from the bearing). Then slide the bearing on, and put the 3/4" collar back on, tightening the screw so that you can slide the bearing up close to the collar to tighten the set screws on the bearing. Reinstall the auger assembly and reinstall the four bolts by hand. Then, lift the bearing assembly straight up and turn by hand to ensure that it turns freely. If it does, tighten the bolts using the 5/16" socket/open ended wrench or 3/8" 12 point socket, in a 'cross' pattern (tightening the screws that are diagonal from each other). If it does not turn freely, move the bearing around until the auger turns freely, then tighten the bolts when you find the smoothest rotation. Reinstall the auger motor by aligning the FLAT side of the motor shaft with the set bolt, and tightening. *Call Technical Support at (800) 245-6489 with any questions.*

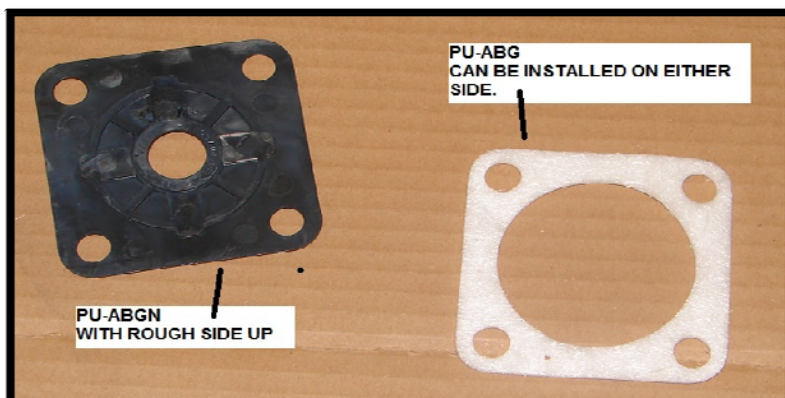

See your owner's manual and service DVD for your specific part number and for more information on checking and replacing bearings and bearing gaskets.

***Call Technical Support at (800) 245-6489 with any questions.***